

Moorlands Road

FISHPONDS

APPROXIMATE FLOOR AREA
97 SQM / 1044 SQFT

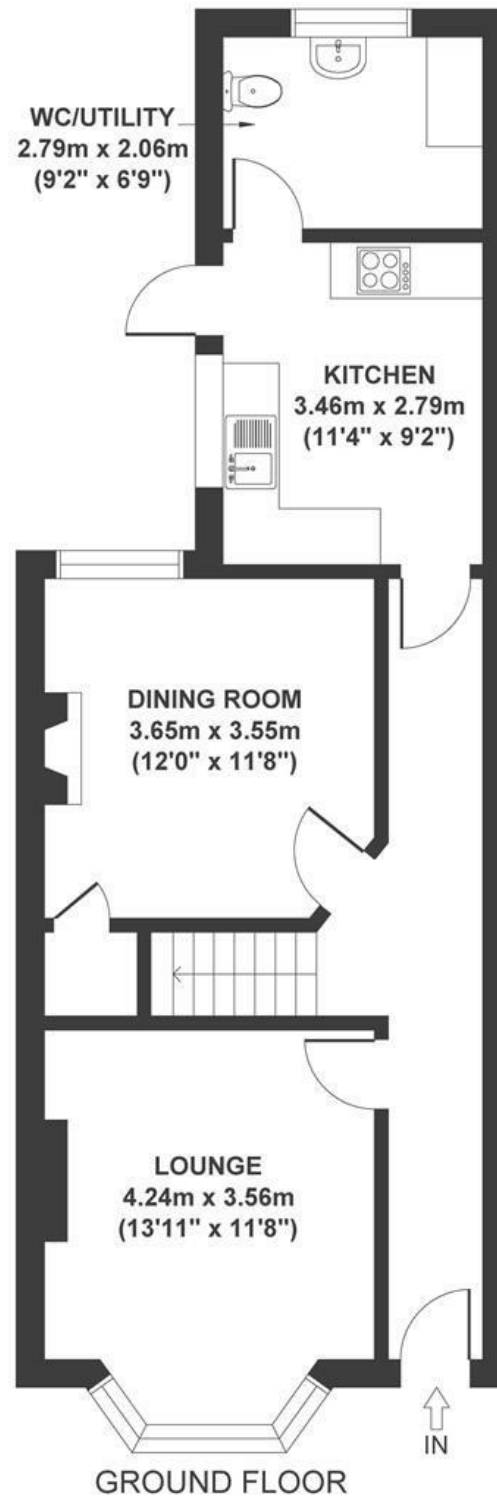

Boardwalk

Moorlands Road

FISHPONDS, BRISTOL



£375,000



2 Bedrooms



BS16 3LF



2 Bathrooms



"Living on Moorlands Road you are surrounded by friendly neighbours and a lovely park a stones throw away, not to mention the super convenient corner shop!"